



## Fairmead Crescent

**£675,000**

1730 sq ft - Located in a prime location, this extended and recently renovated five-bedroom house is in excellent condition. On the ground floor, the property boasts an entrance hallway leading to a spacious reception room, which flows into a further reception room. The open-plan kitchen-diner provides access to the garden, creating a perfect space for entertaining and family gatherings.

The first floor features three bedrooms and a family bathroom. The top floor offers two additional bedrooms and another bathroom, ensuring ample space for a large family or guests.

Further benefits include under floor heating on the entire ground floor, a rear annex, which could be used as a gym or home office, providing versatile extra space. Additionally, the property offers off-street parking and is conveniently close to the amenities of Edgware High Street.

This property is chain-free, making it an ideal choice for those looking to move quickly and without complications. Sole Agent.

- Large Family Home - 1730 Sq Ft
- Recently Renovated
- 5 Bedrooms
- 2 Bathrooms
- 2/3 Reception Rooms
- Off-Street Parking For 3 Cars
- Close To Edgware High Street

### Viewing

Please contact our Mill Hill Office on 02089590011 if you wish to arrange a viewing appointment for this property or require further information.





Floor Plan

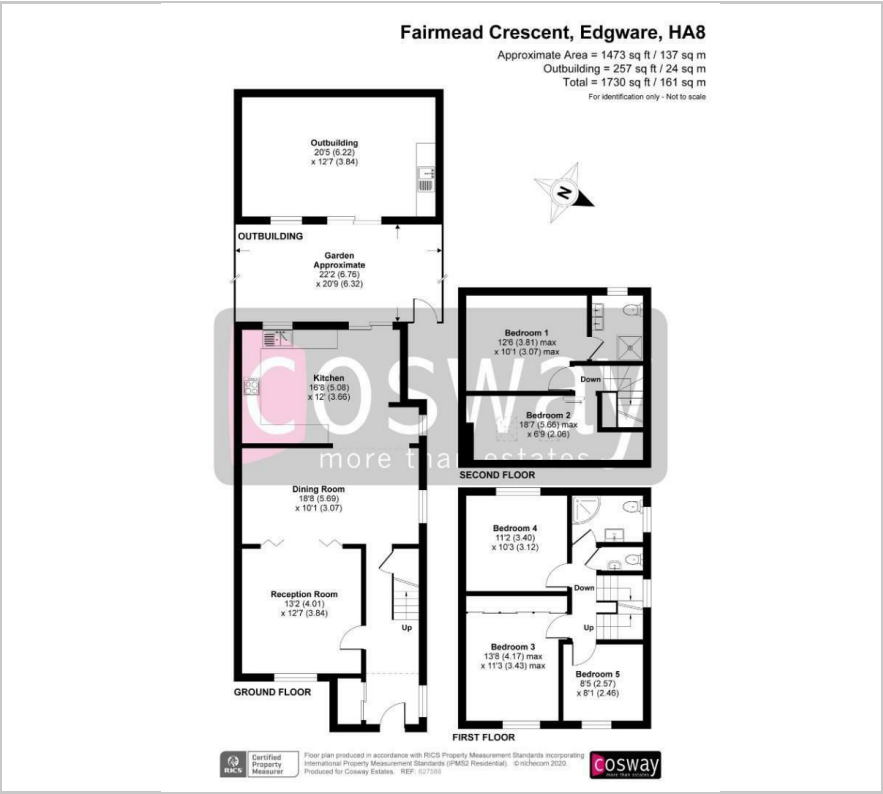

Area Map



Energy Efficiency Graph

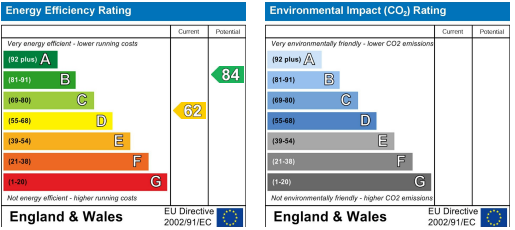

These particulars, whilst believed to be accurate are set out as a general outline only for guidance and do not constitute any part of an offer or contract. Intending purchasers should not rely on them as statements of representation of fact, but must satisfy themselves by inspection or otherwise as to their accuracy. No person in this firms employment has the authority to make or give any representation or warranty in respect of the property.